



***CRIMSON TRACE***<sup>®</sup>



***CRIMSON TRACE***<sup>®</sup>

CRIMSON TRACE HEADQUARTERS • 9780 SW FREEMAN DRIVE, WILSONVILLE, OR 97070  
TELEPHONE: 800-442-2406 • FAX: 503-783-5334 • [CRIMSONTRACE.COM](http://CRIMSONTRACE.COM)

© 2018 Crimson Trace Corporation. All rights reserved.

27-2738 REV001 01/19

**USER GUIDE**

**CTS-1100**



TACTICAL

## PLEASE READ THE ENTIRE MANUAL

FAILURE TO FOLLOW THESE INSTRUCTIONS AND PROCEDURES MAY RESULT IN INJURY OR DEATH.

Always follow firearm safety rules as outlined by the firearms manufacturer.

Keep this and all firearm related products locked and secured from children or other unauthorized users.



### CONTENTS

QUICK START .....	3
KEY FEATURES .....	3
FEATURES AND SPECIFICATIONS .....	4
WINDAGE & ELEVATION ADJUSTMENTS .....	5
HYBRID BDC RETICLE .....	6
MAINTENANCE AND TROUBLESHOOTING .....	6
LENS CARE .....	7
FREE BATTERIES FOR LIFE .....	7
WARRANTY .....	7
BATTERY WARNINGS .....	8



**WARNING: UNLOAD YOUR FIREARM BEFORE INSTALLING OR REMOVING YOUR CRIMSON TRACE SIGHT. FIRST REMOVE THE MAGAZINE FROM THE FIREARM. SECOND, VISUALLY AND MANUALLY CHECK AND CLEAR THE CHAMBER AND ACTION OF AMMUNITION.**

### QUICK START

- **Power On:** With a battery installed, press and hold the power button  for three seconds, to power up the sight to the last used level of intensity.
- **Power Off:** Press and hold the power button  for three seconds to turn off the sight's illumination.
- **Focusing the Reticle:** Turn the reticle focus knob to bring the reticle into focus. It is best to do this when observing a solid color background such as the sky.

### KEY FEATURES

- A. ELEVATION ADJUSTMENT CAP
- B. BATTERY CAP/COMPARTMENT
- C. RETICLE FOCUS ADJUSTMENT
- D. WINDAGE ADJUSTMENT CAP
- E. MOUNTING BOLTS
- F. BASE CLAMP
- G. BRIGHTNESS (+)
- H. BRIGHTNESS (-)
- I. OCULAR LENS
- J. POWER ON/OFF
- K. OBJECTIVE LENS
- L. CR2032 BATTERY

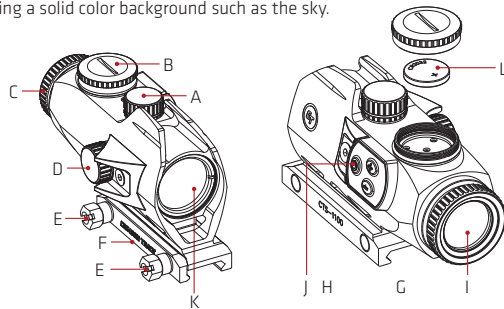

## FEATURES AND SPECIFICATIONS

- **Brightness:** The CTS-1100 reticle is user configurable for 10 levels of brightness. Pressing the "+" button will increase the brightness a single step until the maximum level has been achieved. Pressing the "-" will decrease reticle brightness until the minimum level has been reached. NOTE: the illumination feature is not required for use, the reticle can be used with or without power.
- **Intelligent Power Management:** The CTS-1100 is equipped with intelligent power management to prolong battery life when not in use. After a period of ninety minutes, the sight will automatically shut off to prolong battery life. To reactivate the sight, press and hold the power button to return the previously selected intensity setting.
- **Aiming Reticle:** The CTS-1100 possesses a hybrid BDC reticle for quick targeting and precise aiming. Reticle details can be found on page six.
- **M1913 Mount:** The mount included with the CTS-1100 is compatible with most M1913 rails. To attach the CTS-1100 to the host firearm, loosen both rail clamp nuts and slide the base clamp outward. Place the left side of the clamp on the rail in the desired location and roll the sight onto the rail. Tighten the nuts to secure the sight in place using an 11mm socket, wrench, coin, or large flathead screwdriver. Verify that the eye relief is correct prior to torquing the screws to 30 in/lbs. Clamp cross bolts are contoured and may be rotated to accommodate various rail fits.

**⚠ WARNING: CONFIRM THAT YOUR SIGHT IS SECURELY AND PROPERLY INSTALLED. AN IMPROPERLY INSTALLED SIGHT COULD BECOME DETACHED DURING RECOIL CAUSING INJURY.**

- **Battery:** The CTS-1100 is powered by a single CR2032 battery. This battery will provide most users with years of maintenance free service. Depending on reticle intensity, ambient conditions and use, battery life may vary.

## WINDAGE AND ELEVATION ADJUSTMENTS

The CTS-1100 is fully adjustable for both windage and elevation. The adjustment screws are located on the top and right side of the sight body underneath the protective caps. Both adjustment screws are able to be turned with a cartridge case rim, coin or small screwdriver. Each click represents .5MOA of movement or approximately 1/2 inch at 100 yards.

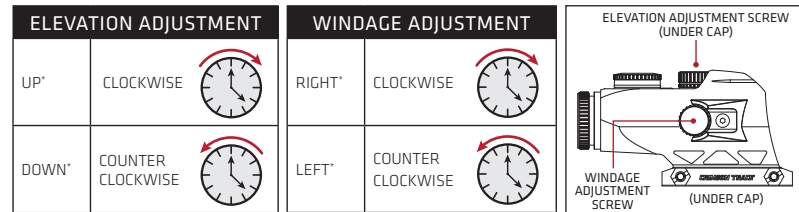

**NOTE:** Adjustments to both the windage and elevation knobs reference your Point of Impact (POI). Should your impacts be below your point of aim, dial UP to reach zero. For additional information visit [www.crimsontrace.com](http://www.crimsontrace.com).

### HYBRID BDC RETICLE

The CTS-1100 contains a hybrid BDC reticle. The reticle contains ballistic holdovers calibrated for popular rifle calibers fired from AR15 and similar style rifles. Always be sure to verify your specific ballistic details prior to using this guide.

Although the CTS-1100 can be zeroed at any distance, Crimson Trace recommends a 100 yard zero for best results. This diagram illustrates the distance from zero to each hold over line in MOA (minute of angle). Use this guide along with your known ballistics for your firearm/ ammunition combo to calibrate the BDC tree for engaging targets at various distances.

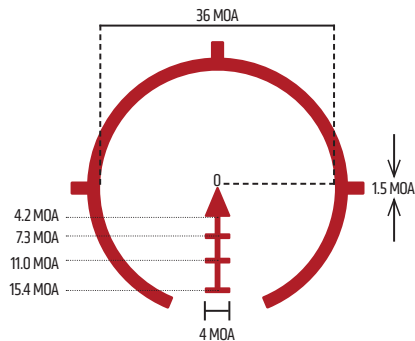

### MAINTENANCE AND TROUBLESHOOTING

The CTS-1100 requires minimal maintenance, the included CR2032 battery should provide years of service for most users. Should your sight fail to power up, remove and replace the battery with a new CR2032 from a reputable manufacturer. Should problems persist please contact Crimson Trace® customer service for additional technical support at 800-442-2406 or email [customer@crimsontrace.com](mailto:customer@crimsontrace.com).

### LENS CARE

The external optics of the CTS-1100 are generally resistant to scratches and common firearm cleaning chemicals. Periodically the optics may become dirty from normal use, Crimson Trace recommends using the included microfiber cloth for periodic cleaning. Should the sight become excessively dirty, gently rinse the sight with soap and water prior to using the included microfiber cloth on the optics.

### FREE BATTERIES FOR LIFE

Your product qualifies for Free Batteries For Life! Product registration required and other terms and conditions apply. For information please visit [www.crimsontrace.com/support/free\\_batteries\\_for\\_life](http://www.crimsontrace.com/support/free_batteries_for_life), or call 800-442-2406.

### 3 YEAR WARRANTY

Crimson Trace Corporation (CTC) warrants that this product will be free from defects in materials and workmanship for a period of three years from the date of original retail purchase. Terms and conditions apply. For complete warranty information please visit [www.crimsontrace.com/support/warranty](http://www.crimsontrace.com/support/warranty), or contact CTC at the address / telephone number listed on the back of this User Guide.

For warranty service call Customer Service at 800-442-2406, or email [customer@crimsontrace.com](mailto:customer@crimsontrace.com) for a Return Authorization Number (RMA).

## BATTERY WARNINGS

 **WARNING: IF A BATTERY OPERATED ACCESSORY OR ATTACHMENT (I.E. LASER, OPTICAL SIGHT OR FLASH LIGHT, ETC.) IS SUPPLIED OR USED WITH THIS FIREARM, THE FOLLOWING WARNINGS AND INSTRUCTIONS MUST BE ADHERED TO.**

 **WARNING: KEEP BATTERIES AWAY FROM CHILDREN. THERE IS A CHEMICAL BURN HAZARD ASSOCIATED WITH BATTERIES.**

 **WARNING: IF A NEW OR USED LITHIUM BUTTON/COIN CELL BATTERY IS SWALLOWED OR ENTERS THE BODY, IT CAN CAUSE SEVERE INTERNAL BURNS AND CAN LEAD TO DEATH IN AS LITTLE AS 2 HOURS. ALWAYS COMPLETELY SECURE THE BATTERY COMPARTMENT. IF THE BATTERY COMPARTMENT DOES NOT CLOSE SECURELY, STOP USING THE PRODUCT, REMOVE THE BATTERIES, AND KEEP IT AWAY FROM CHILDREN. IF YOU THINK BATTERIES MIGHT HAVE BEEN SWALLOWED OR PLACED INSIDE ANY PART OF THE BODY, SEEK IMMEDIATE MEDICAL ATTENTION.**

- When used correctly, batteries provide a safe and dependable source of portable power. However, misuse or abuse may result in leakage, fire, or explosion.
- Batteries can explode or leak and cause burns if installed backwards, disassembled, charged, or exposed to water, fire or high temperature.
- Always take care to install your batteries correctly observing the "+" and "-" marks on the battery and the device.

- Always replace the whole set of batteries at one time, taking care not to mix old and new batteries, or batteries of different types.
- Store unused batteries in their original packaging and away from metal objects that may short-circuit them.
- Remove discharged batteries from equipment promptly to avoid possible damage from leakage.
- Never dispose of batteries in fire. (Failure to observe this precaution may result in an explosion.)
- The batteries are supplied in a charged state, and are not designed for recharging. Recharging may cause leakage, fire, or explosion.
- The batteries should be disposed of properly, including keeping them away from children.
- Dispose of used batteries immediately. Even used batteries can cause injury.

