

Crimson Trace™

INSTALLATION INSTRUCTIONS

OWNER'S MANUAL ADDENDUM FOR:

LG-411
Ruger LCR

L A S E R G R I P S®
Please read entire Owner's Manual prior to
installing and using your new Lasergrips.

Thank you for selecting the finest laser sighting system:
Crimson Trace Lasergrips.

When it comes to speed, accuracy and security, Crimson Trace is
the top choice of law enforcement, militaries and legally armed
citizens around the world.

OPERATING INSTRUCTIONS

The LG-411 is activated by a strategically located pressure pad. With a normal shooting grip,
your middle finger will naturally hit the pressure pad whether shooting right or left-handed.

Master ON/OFF switch is also provided near the bottom of the right-side panel to turn the laser
off. The laser should be left in the "ON" position under most circumstances. **Turning the mas-
ter switch "OFF" will NOT increase battery life.**

INSTALLATION INSTRUCTIONS

1. Make sure firearm is unloaded. (See "Four Basic Rules Of Firearm Safety" in Owner's Manual).
2. Remove the screw holding the factory grip in place. Also refer to Ruger Owner's Manual for grip removal instructions.
3. Remove existing grip.
4. Place one battery straight down into each battery well on, with the flat, (+) side visible.
5. Align both right and left grip panels with the frame and tighten both down using the two screws provided in accessory pack.
6. To activate Lasergrips, push the master ON/OFF switch forward to ON position. The switch is located on the bottom right-side of the Lasergrips. Press pressure activation switch located in center of rubber front strap directly beneath trigger guard.
7. Confirm that laser and iron sights are in alignment. Laser dot should rest on top of front site post with correct iron sight picture. Lasergrips are sighted-in at the factory to 50', but can be fine tuned for windage and elevation. (See Lasergrips Owner's Manual for complete sighting info.)

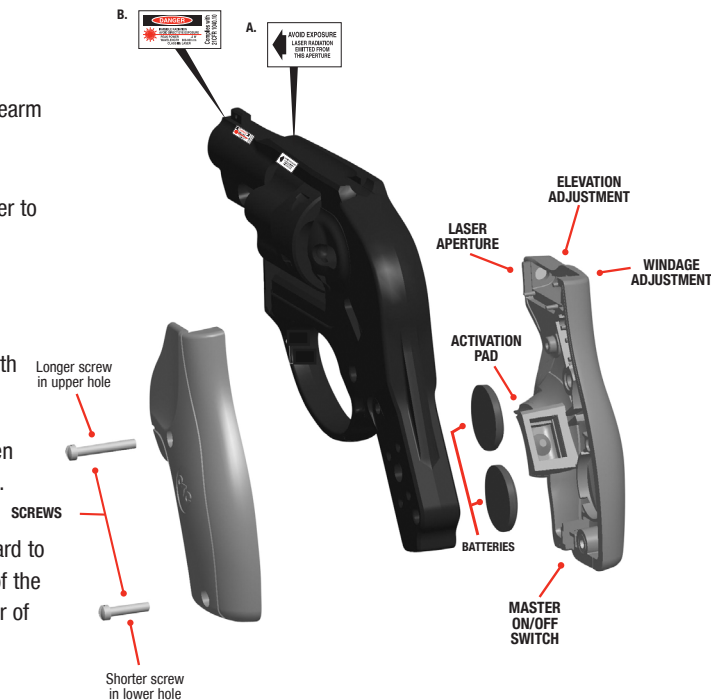

BATTERIES:

Two (2) CR2032 or
DL2032 lithium cells.

LASER SAFETY LABELING

**IMPORTANT: LASER PRODUCTS MUST ONLY
BE OPERATED WITH THE SAFETY LABEL
APPLIED TO THE FIREARM.**

Labels could not be affixed to the product
but are supplied and must be installed as
indicated below:

- A. Attach the "Danger" warning label to the out-
side of the firearm.
- B. Attach the "Aperture" warning label with the
arrow pointing to the laser aperture.

Use caution when activating the laser to avoid
direct eye exposure, which can result in per-
manent eye damage. Follow all precautions as
outlined by the firearms manufacturer. Keep
this and all firearm related products locked and
secured from children or other unauthorized
users.

**MADE
IN USA**

27-4137 Rev02

Phone: (800) 442-2406 or (503) 783-5333 / Fax: (503) 783-5334
Customer Service E-mail: customer@crimsontrace.com
www.crimsontrace.com
9780 SW Freeman Drive, Wilsonville, OR 97070